

## Description

With the **WiFi Power Socket**, you can control multiple home appliances from phone or tablet anytime anywhere. Turn on or turn off the home appliances by click the software or at a fixed time Delay turning off function available.

You can control appliances in local WiFi network or even in the external 3G or 4G networks.

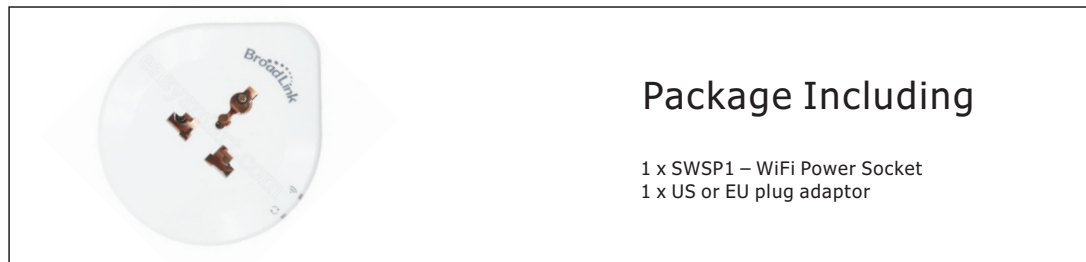

## Install APP in Smart Phone

Please scan below QR codes or input download links to your mobile phone or tablet to install the app.



### BLSmartPlug

Compatible with iPhone 3GS~5  
iPod touch 3rd~5th and iPad.  
Requires iOS 5.0 or later.  
\* Chinese language only \*  
Url: <http://trix.ws/DAaSo>



### Switch.APK

Compatible with Android phones / tablets.  
Requires Android V2.3 or later.  
\* Has both of English and Chinese \*  
Url: <http://trix.ws/34x94>

## Connect to AC Power Socket

1) Connect the WiFi power socket to AC power socket.

**\*\* WiFi power socket has Chinese standard plug, if its not fit to your power socket, please use the plug adaptor which is shipped with your order.**

2) Connect home appliance to the universal socket on WiFi power outlet.

**\*\* WiFi power socket has universal outlet socket to fit to many kind of plugs.**

WiFi power socket's working voltage is AC 90 volt to 245 volt. So it can works on all of universal AC power sockets.

WiFi power socket's working current is 10A and rated power is 2200Watt.

**\*\* Please make sure do NOT connect to any home appliances which has more than 10A current and more than 2200Watt power.**

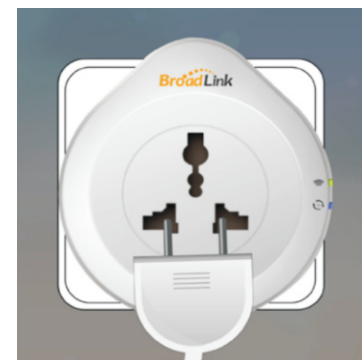

## Config WiFi Network for Power Socket

Open APP and click "Config" will goto below interface. Input WiFi SSID and password. Then click "Config". You can view the "Configuring" status bar.

After successfully configured the indicator in WiFi power socket will stay in yellow light. Click "System" you can find the paired WiFi power socket in "Device List". You can change name and symbol of it.

If configure was failed the indicator is still flash the yellow color. Long press the button switch on WiFi power socket until the indicator turn off. Then release the button will reset to factory settings. The indicator will flash yellow color. Then config again.

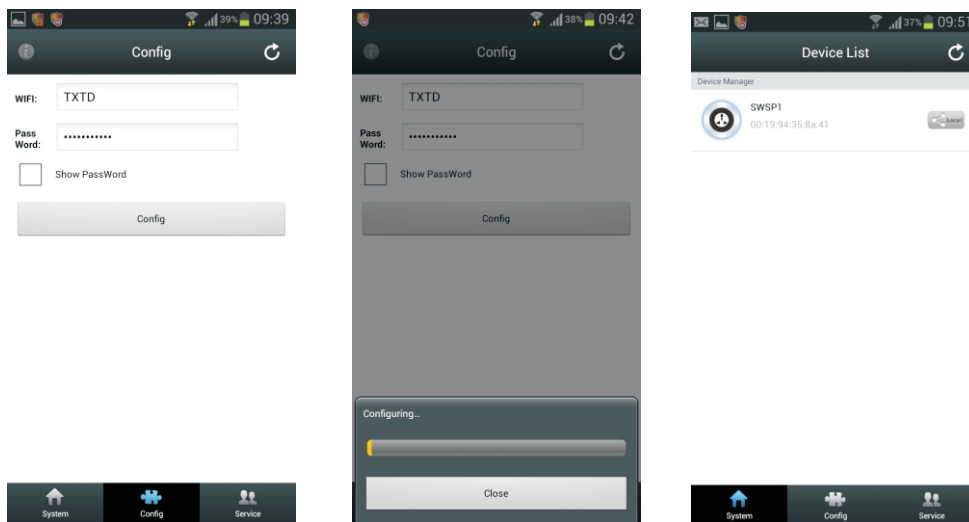

## Setup the WiFi Power Socket

Click on the device list you can open interface to control power turn on or turn off. Click settings you can setup "Device Info", "Timer Task" and "Delay Operation".

In "Device Info" you can change name, symbol and LOCK the device.

In "Timer Task" you can setup turn on/off time.

In "Delay Operation" you can turn off the power after few minutes later.

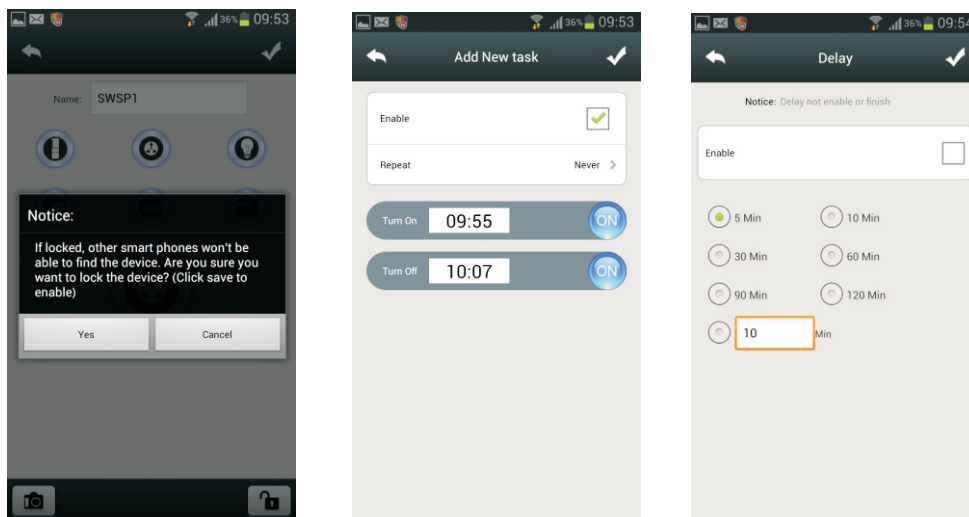

## FAQs of WiFi Power Socket

Q. How to "Add" and "Delete" WiFi power socket from mobile App?

A. You can connect multiple WiFi power sockets into mobile App. Max connection is 100 units. To distinguish from different WiFi power sockets, you can rename them and change the icon.

After finished "Settings", go to Home "System", it will alert "Searched new devices", click it to add new device to control list. To delete WiFi power socket device, in control list select device then slip to right size to delete it.

Q. What does status of "Offline" "Local" "Remote" means?

A. Offline -- Means device is not connect to WiFi network. Please check WiFi router or ethernet cable.

Local -- Means mobile phone and WiFi power socket in the same WiFi network.

Remote -- Means mobile phone and WiFi power socket are not in the same WiFi network. Mobile phone can control the WiFi power socket in 4G 3G or GPRS networks. The response speed is depends on the internet speed.

Q. What's the max output power of WiFi power socket?

A. WiFi power socket output max 10A current and 2200Watt power. Please ensure connected devices not exceed rated power and current.

Q. If WiFi power socket is safe in the WiFi network?

A. 1) Only people who connect to your WiFi network could find the WiFi power socket device;

2) You can lock the WiFi power socket in mobile phone App. After locked it others can not find WiFi power socket device in WiFi network.

Q. How to use timer function?

A. Click "Delay timer" in left bottom corner in "Settings". You can setup max 7 units in the delay timer and choose if repeat the timer weekly.

Q. What is delay function?

A. With delay function you can turn on/off xx minutes later depends on your needs.

## Remarks

1) Do not open the housing unless have our formal authorization;

2) Keep WiFi power socket far away from water and fire;

3) Please unplug from power socket if long time not use it.

Thank you for reading. If you have any question about the product please click "[Chat with us](http://easysmart.com)" in <http://easysmart.com>" to get instant helps from our sales team. You can also send email to "[astor.y@easysmart.com](mailto:astor.y@easysmart.com)" to ask for help.